

From Scientists to Innovators for Industry

PARTICIPANT'S LIGHT PROGRAMME GUIDE



SCI FI



Transitioning from academic research to working in the Pharma and Medtech industries can be challenging. This course helps you overcome that challenge with the guidance of academic and industry partners, so that you can learn from real-life cases and increase your skill set needed in an industrial setting .

Through our three-month blended-learning programme we aim to facilitate the transition from an academic research environment to the working world of the industry. With the support of our industry partners, we want to ensure that you receive crucial skills needed for this transition to an industry setting - soft skills, creative skills, business skills and industry specific skills.



**Challenge-based,
blended learning**



**Top-notch experts from
industry, business
and academia**



**Access to industry,
access to best talents**



About the guide

The purpose of the document is to collect all information relevant for SCI FI Participants:

- Timeline
- Bonus modules
- Structure of modules

SCI FI starts on 1 September and ends on 12 December.

Within SCI FI you will work using MOODLE and SLACK. All links will be shared on 1 September.

Timeline

September

1 - 15 Sept; MOODLE

Module 1

Communication & Collaboration

15 Sept - 6 Oct; MOODLE

Module 2

Understanding your Customer
& Design Thinking

October

13 Oct - 27 Oct; MOODLE

Module 3

Strategic Management

27 - 3 Nov; MOODLE

Module 4

Project Management

November

10 - 17 Nov; MOODLE

Module 5

Operational Management

17 - 24 Nov; MOODLE

Module 6

Intellectual Property Rights

24 - 8 Dec; MOODLE

Module 7

Market Access & Pricing



Bonus modules

In addition to the basic modules you can also take part in bonus modules (at least 1 bonus module has to be completed). First, two Bonus modules will be opened on the 29th of September. The three remaining Bonus modules will be opened will be open on October 27th.

29 September

- GDPR and Patient Data
videos & quizz
- Clinical Process
videos & quizz
- Digital Transformation
videos & quizz

27 October

- How to engage? Insider's views to value creation
videos & quizz
- Medical Device Regulation
videos & quizz



Structure of modules

Friday #1 - Friday #2 (following week)

Mandatory
readings

Further
reading
(optional)

Videos with
quizzes

SLACK

By Sept 1st, you should have received an invitation.
SCI FI /From Scientists to Innovators for Industry

You should have these channels, with a description on how to use each of the channels once you open them.

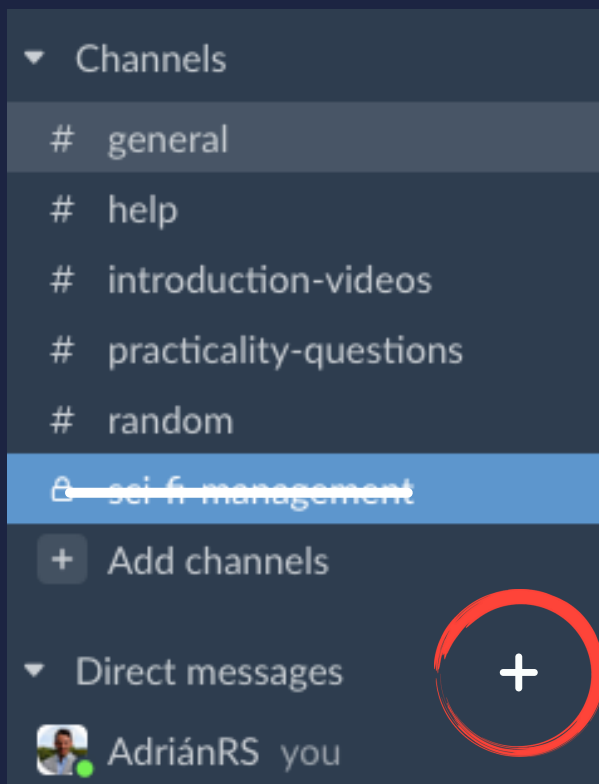

Click here to send direct messages to an individual person or a group of people.

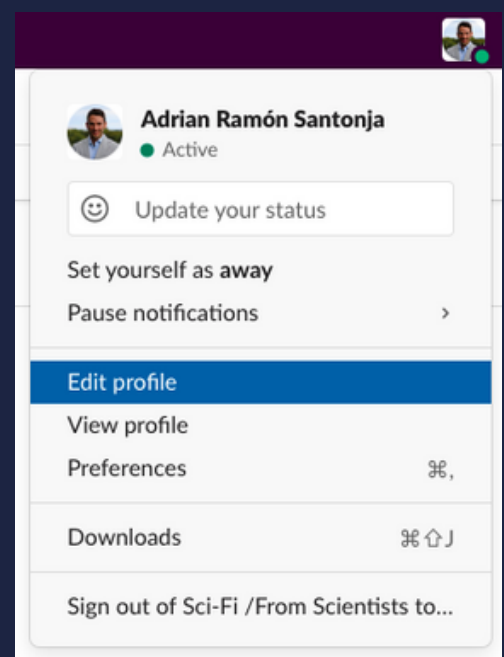

When you open your Slack account, add a profile picture so it is easier to recognize you and make sure your username is correct.

MOODLE

You can log in to the Moodle platform via <https://sci-fi.network/>

Should be completed before 10th
September

You can adjust your
profile and page.
You can send
message to others

The screenshot displays the Moodle platform interface for the 'SCI FI - Full Programme'. The dashboard includes a 'Course overview' section with a progress bar for the 'INTRODUCTION' module. The main content area lists course modules: 1. Communication & Collaboration, 2. Understanding your customer & Design Thinking, 3. Strategic management, 4. Problem Solving & Critical Thinking, 5. Project management, 6. Operational management, 7. Market access & pricing, and a 'C. FINAL event'. There are also 'BONUS' modules for Digital transformation, Intellectual property rights, and Medical device regulation. The sidebar on the right shows 'Upcoming events', a 'Calendar' for August 2021, a 'Level up!' section with a progress bar, and 'External tools' like SLACK and MIRO. The user profile 'John Smith' is visible in the top right corner.

Deadlines within
next 2 weeks

You can import all
deadlines to your
calendar

You can monitor
your progress

Access to SLACK

Contact to Activity
Leader and
Technical Support

MOODLE - Calendar

If you don't want to miss any event or deadline, export all dates to your calendar.

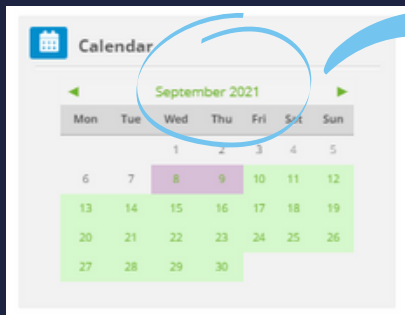

Click on 'September 2023'

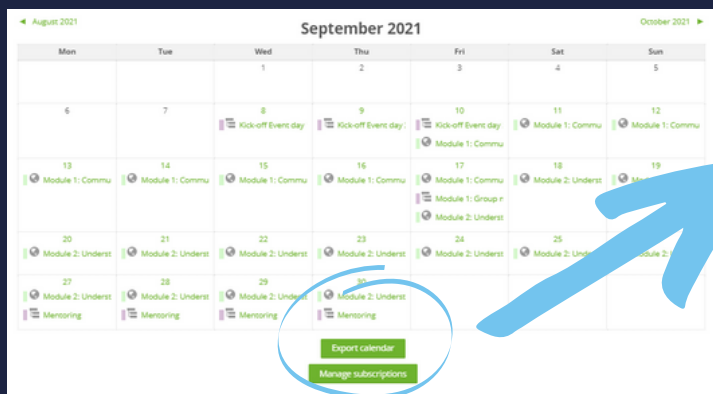

Click on 'export calendar'

Select type of events and time.
Export SCI FI calendar to your
personal calendar.

Export calendar

① How do I subscribe to this calendar from a calendar application (Google/Outlook/Other)?

Events to export①

- ☐ All events
- ☐ Events related to categories
- ☐ Events related to courses
- ☐ Events related to groups
- ☐ My personal events

Time period①

- ☐ This week
- ☐ This month
- ☐ Recent and next 60 days
- ☐ Custom range (11/08/21 - 16/08/21)

[Get calendar URL](#) [Export](#)

There are required fields in this form marked ①.

MOODLE - Intro & Goodbye

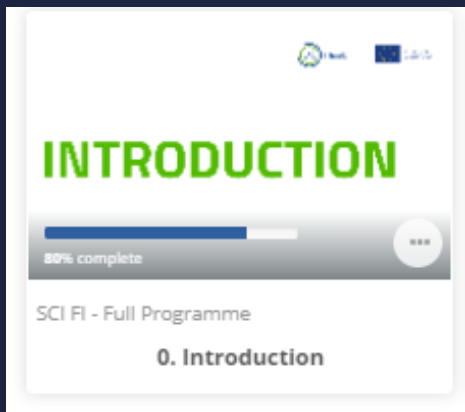

In the Introduction you will find general information about SCI FI, structure, partners.

You will also access your 1st Task 'SELF EVALUATION QUIZ'.

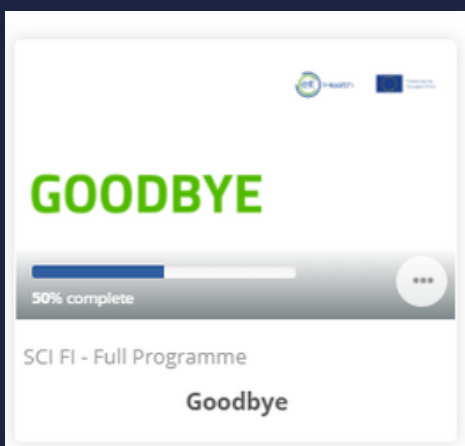

In this part you will find a link to register to the EIT Health Alumni network, you will be able to fill in the post-programme survey and download a certificate confirming participation in SCI FI (if you have paid the fee for it).

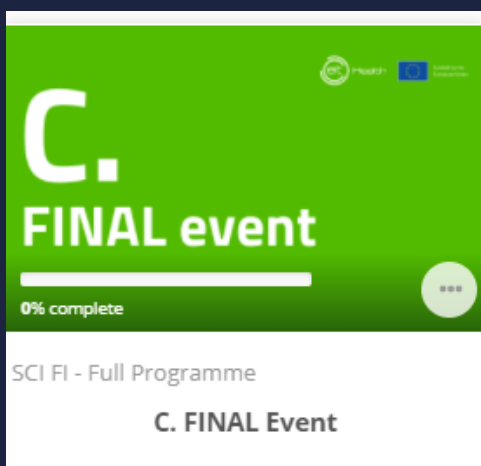

In this section you will find invitation to the Recruitment event including:

- short description of the event,
- date and time of the event,
- link to the online event,
- agenda,
- BIO of Keynote speakers.

MOODLE -Modules

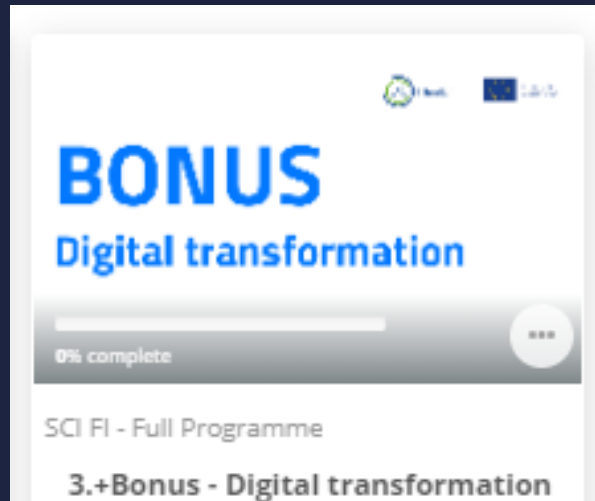
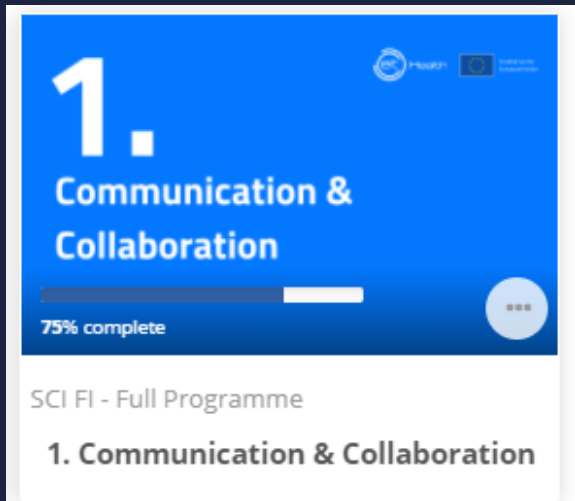

As part of the Modules you will find:

- Introduction to the module (giving you an outline of the content)
- Preparation (prior to the content)
- Further information (for more in depth information)
- Main content (where you access the video clips)
- Quiz (to see if you have understood the content)
- Module feedback (with a short survey on the how you liked the content)

Please note: modules will be 'unlocked' corresponding to the timeline (Fridays at 5pm), when you are supposed to take the modules.

SCI FI Team



one of the best medical Universities in Poland

Marcin Ciszewski - Project Coordinator



Friedrich-Alexander-Universität
Erlangen-Nürnberg

**#1 in Germany and ranked
#2 in Europe at the Reuters innovation ranking**

**Heike Leutheuser
Victoria Goldberg**



Maastricht University

brings expertise of 6th best young university worldwide

**Mark Govers
Rudy Schreiber**



OLLSCOIL NA GAILLIMHE
UNIVERSITY OF GALWAY

top 1% Universities in the World

**Neil Ferguson
Natalie Walsh**



MEDICAL
UNIVERSITY
OF GDAŃSK

member of an elite group of the best 10 Polish universities

Karolina Irmgard Kądziela



Karolinska Institutet

largest centre of medical academic research

Anna Birgersdotter



Boehringer Ingelheim

one of the world's leading research-driven pharmaceutical companies focused on creating Value Through Innovation

Vicktoria Koudela

PHILIPS

leader in health technology improving people's health and well-being through meaningful innovation

**Maciej Kuć
Sjoerd Mentink**



living Lab specialized in the evaluation of technologies and service

Raphael Koster



innovation centre acting as Ecosystem Builder focusing on digital innovation for society

Adam Červenka



catalyst, driving healthcare improvement through innovation

Ion Petrovai

SCI FI Team



Barcelona Institute of
Science and Technology

**A leading institution of
multidisciplinary research in Barcelona**

Elena Redondo



**Fundació Institut de
Bioenginyeria de Catalunya**

Cristina Arimany



**Institute for Research in
Biomedicine**

Leyre Caracuel



**A unique and interdisciplinary centre
at the forefront of life science**

Damjana Kastelic



**Developing top-level
scientific research**

Marc Delage



**Leading competitiveness
cluster, innovative technologies
in health & new therapies.**

Hickmah Tagauly



More Information

Visit SCI FI website

<https://eithealth.eu/programmes/sci-fi/>

Register to EIT Health Alumni Network

<https://alumni.eithealth.eu/>

If you have any questions please contact
marcin.ciszewski@umed.lodz.pl